

South Central Alabama Comprehensive Economic Development Strategy 2024 Annual Report

Acknowledgments

Funding for the CEDS is provided by the U.S. Department of Commerce, Economic Development Administration and matching funds by the South Central Alabama Development Commission and its member governments.

SCADC BOARD OF DIRECTORS

Chair	Mildred Whittington
Vice-Chair	Melissa Sanders
Secretary	Lawrence Haygood
Treasurer	Jackie Thomas

BULLOCK COUNTY

Roderick Clark, Mayor of Union Springs
Alonza Ellis, Jr., Chairman, Bullock County Commission
David Padgett, Bullock County Development Authority
Mildred Whittington, Mayor, Town of Midway

BUTLER COUNTY

David Hutchison, Butler County Commission for Economic Development
Dexter McLendon, Mayor, City of Greenville/ Business
Allin Whittle, Butler County Commission
Steve Norman,

CRENSHAW COUNTY

Darryl Elliot, Council, Town of Brantley/ Business
Charlie Sankey, Jr., County Commission Chair/ Business
William A. Tate, Probate Judge
Vacant Seat

LOWNDES COUNTY

Charlie King, Lowndes County Commission
Jacquelyn Davison-Boone, Mayor, City of Fort Deposit
Jaqueline Thomas, Lowndes County Commission/Business
Ransom Williams, Bankcorp South/Private Business

MACON COUNTY

Louis Maxwell, County Commission Chair
Lawrence Haygood, Mayor, City of Tuskegee
Vacant Seat
Vacant Seat

MONTGOMERY COUNTY

Steven Reed, Mayor, City of Montgomery
Vacant Seat
Vacant Seat

PIKE COUNTY

Chad Copeland, Pike County Commission
Isabell Boyd, Mayor, City of Brundidge
Marsha Gaylard, Pike County Economic Development Commission
Jason Reeves, Mayor, City of Troy/ Business
Melissa Sanders, City of Troy

CEDS COMMITTEE

WORKFORCE DEVELOPMENT

Anna Buckalew, Montgomery Chamber of Commerce
Ashley Johnson, Central Alabama Works!
Kathy Smyth, Southeast Alabama Works!

INSTITUTIONS OF HIGHER EDUCATION

Judson Edwards, Troy University
Mary Mitchell, Lurleen B. Wallace Community College - Greenville

MINORITY & LABOR GROUPS

Darryl Elliott, Town of Brantley

PRIVATE SECTOR/ INDIVIDUALS

Thomas Ellis, Priester Pecan Company
Andy Kimbro, South Alabama Electric Cooperative
Jerry Ingram, Town of Lowndesboro
William Johnson, Community Neighbor Bank
Rick Pate, Pate Landscape Co.
Ransom Williams, Bank of Hayneville

COMMUNITY LEADERS

Dr. Melissa T. Williams, Macon County Schools
Jennifer Kilpatrick, South Central Alabama Area Agency on Aging
Jacqueline Thomas, Lowndes County

LOCAL OFFICIALS

Jacquelyn Davison-Boone, City of Fort Deposit
Lawrence Haygood, Jr., City of Tuskegee
Ed McCurdy, Town of Lowndesboro
Louis Maxwell, Macon County Commission
Dexter McLendon, City of Greenville
Willie Mae Powell, Town of Shorter
Jason A. Reeves, City of Troy
Henry Peavy, Town of Franklin
Mildred Whittington, Town of Midway

ECONOMIC DEVELOPMENT

Jim Byard, Lowndes County Economic Development Commission
TBD, Pike County Economic Development Corporation
David Hutchinson, Butler County Commission for Economic Development
David Padgett, Bullock County Development Commission
Tucson Roberts, Economic Development Consultant
Robyn Snellgrove, Crenshaw County Economic and Industrial Development
Joe Turnham, Macon County Economic Development Authority

For Additional Copies, Contact

SCADC
SOUTH CENTRAL ALABAMA
DEVELOPMENT COMMISSION

5900 Carmichael Place | Montgomery, AL 36117
P 334.244.6903 | F 334.271.2715 | SCADC.NET

TABLE OF CONTENTS



*Pre-Bid Site Review,
South Central Alabama
Mental Health Rural
Crisis Center, Brantley*

ADOPTION RESOLUTION	FACING PAGE 1
---------------------------	---------------

INTRODUCTION	1
Jurisdiction and Purpose	1
CEDS Structure	2

REGIONAL UPDATE	5
Population	5
Economic Characteristics	6
Investment and Development Trends	7

STRATEGIC DIRECTION IMPLEMENTATION	9
Vision Statement and Goals	9
Economic Development	10
Infrastructure and Transportation	11
Education and Workforce Development	12
Planning and Environmental Stewardship	13
Quality of Life	14
Economic Leadership and Funding	15
Priority Regional Capital Improvement Projects	16

*The 2024 South Central Alabama
CEDS Annual Report
was approved by resolution by the
South Central Alabama Development Commission
Board of Directors on November 20, 2024.*

SOUTH CENTRAL ALABAMA DEVELOPMENT COMMISSION

RESOLUTION

**2024 South Central Alabama Comprehensive Economic Development Strategy
Annual Report**

WHEREAS, the Economic Development Administration (EDA) requires all Economic Development Districts (EDD) receiving Investment Assistance to prepare a new planning document referred to as a Comprehensive Economic Development Strategy (CEDS) every five years, along with a CEDS Annual Report every year, pursuant to 13 CFR, Sections 303.6 and 303.7; and

WHEREAS, the Public Works and Economic Development Act of 1965, as amended (PWEDA), requires a current CEDS be in place for any local government bodies applying for investment assistance under EDA's Public Works or Economic Adjustment Assistance Programs; and

WHEREAS, the South Central Alabama Development Commission prepared the 2022 South Central Alabama Comprehensive Development Strategy according to the guidelines provided in 13 CFR 303.7 and through consultations with the SCADC CEDS Committee and has prepared the 2024 CEDS Annual Report for review by local, state, and federal agencies as required by EDA.

NOW THEREFORE BE IT RESOLVED THAT, the South Central Alabama Development Commission, acting by and through its Board of Directors, adopts the 2024 South Central Alabama Comprehensive Economic Development Strategy (CEDS) Annual Report and all amendments made in necessity throughout the 2024 program year to facilitate public works projects benefitting the SCADC district member governments, contingent upon no comments provided within the comment period; and

BE IT FURTHER RESOLVED THAT, Tyson Howard, or the current Executive Director, is hereby authorized and directed to execute all required documents to EDA regarding the 2022 CEDS and the 2024 CEDS Annual Report planning documents on behalf of the South Central Alabama Development Commission.

Adopted this 20th day of November 2024.

Mayor Mildred Whittington, Chairman

ATTEST:

Beth Rosser

INTRODUCTION

Following on Executive Orders from the governor, Alabama Legislative Act Number 1126 was adopted on September 13, 1969, authorizing the legal organization of groups of Alabama counties into regional planning and development districts. The South Central Alabama Development Commission (SCADC) is now one of twelve regional planning and development commissions in Alabama. The South Central Alabama Development Commission was incorporated as a non-profit organization in June 1969, and was originally called the Central Alabama Economic Development District.

The agency was also designated as an Economic Development District (EDD) by the U.S. Department of Commerce, Economic Development Administration (EDA) in November 1970. The EDD office is located in Montgomery. In April 1971, the Governor designated the Central Alabama Economic Development District as the Regional Planning and Development Commission for State Planning and Development Region No. 5. In May 1971, it was also designated the Area Wide Clearinghouse for the same geographic region. At that time the name was changed to the South Central Alabama Development Commission.

JURISDICTION AND PURPOSE

The South Central Alabama Economic Development District (SCAEDD) includes seven counties: Bullock, Butler, Crenshaw, Lowndes, Macon, Montgomery, and Pike Counties. Only Montgomery County is not located in the regional jurisdiction of the South Central Alabama Development Commission. Montgomery County, along with Autauga and Elmore Counties comprise the Central Alabama Regional Planning and Development Commission. The seven counties in the South Central EDD are designated as redevelopment areas by EDA. Currently, there are 28 incorporated municipalities in the district. Montgomery serves as the major growth center. Historically, Greenville and Troy have served as secondary growth centers; however, Pike Road now moves into the category of a secondary growth center, as well. All member governments have the opportunity to participate in the CEDS process.

Planning for physical, economic and social development within the EDD region is more important than ever given today's economy and the continued



*Playground at Ramage Park,
Brundidge, Pike County*

South Central Alabama Economic Development District

7 Counties

28 Municipalities

Area = 4,025.23 Square Miles

2020 Population = 334,408 Persons

2022 Population = 332,994 Persons

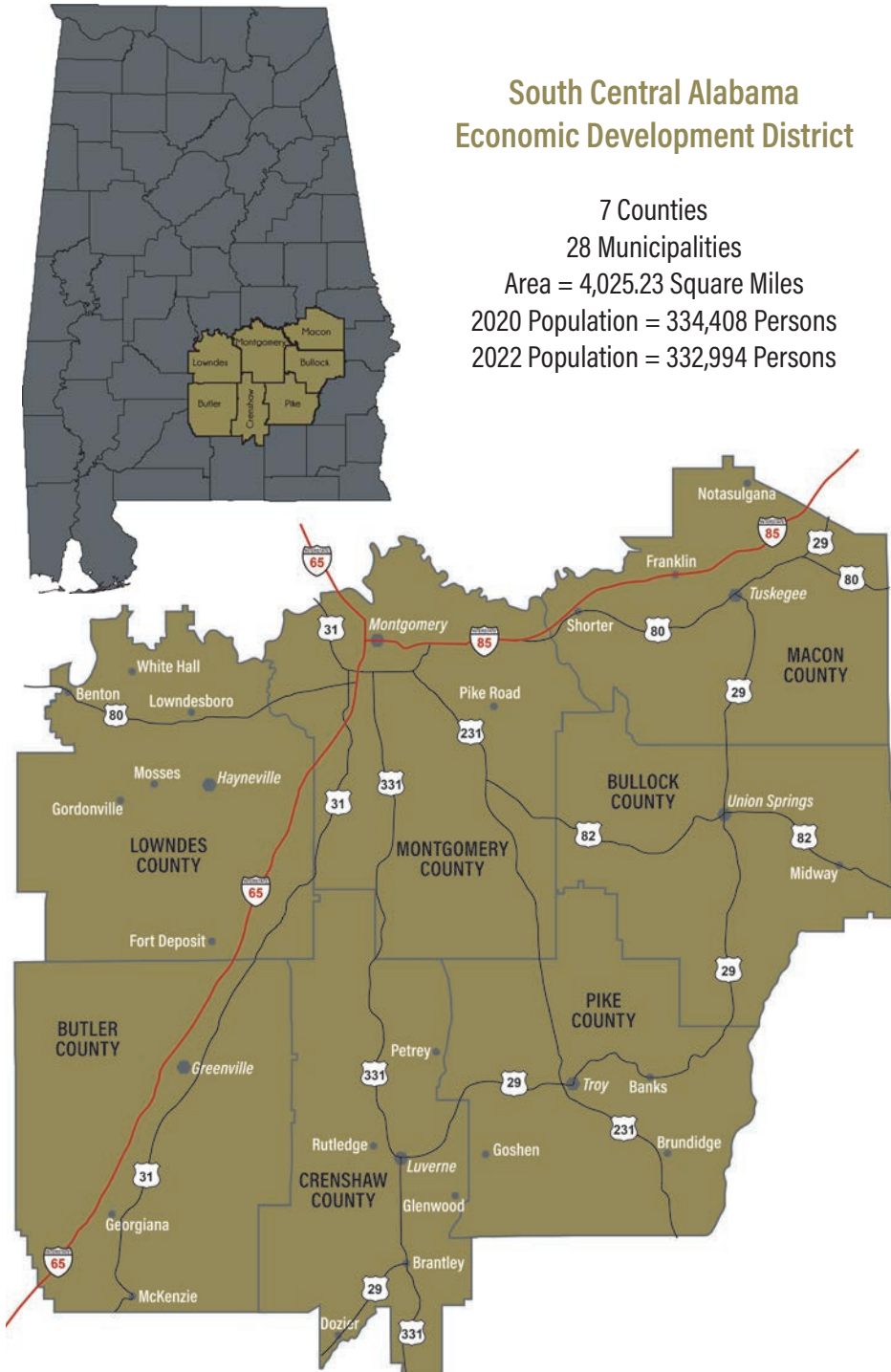

needs of rural areas, especially those that are economically depressed, as well as in growing parts of the region that are experiencing unprecedented opportunities for development. The formation of multi-county initiatives is critical for well-planned development and redevelopment of the area economy. Development projects that cannot be accomplished on a single county basis become possible through the joint efforts of several counties and impact the entire region.

The purpose of the CEDS is to provide an overview of the region's economy and to outline a development strategy, as well as associated projects, that will increase the overall economy and quality of life in the region. The 2022 CEDS was prepared as a continuing step toward successful economic improvement for the South Central Alabama region. Since planning is a continuing process, the proposed projects and goals are continually updated to meet the needs of a constantly changing environment. The South Central Alabama CEDS is also coordinated with statewide plans for economic development and is consistent with statewide plans and policies.

The planning and development program in South Central Alabama results from public and private organizations and individuals in the seven county area joining together in a combined effort to facilitate economic development regionwide. This combined effort is guided by the South Central Alabama Comprehensive Economic Development Strategy, or CEDS, which is developed and updated every five years by the SCADC, who also provides an annual report each year. The counties within the region have elected to have the district CEDS document serve their planning needs and designation obligations.

CEDS STRUCTURE

The CEDS planning process and resulting document must meet the federal requirements set forth in Title 13 of the Code of Federal Regulations (13CFR) Sections 303.6 and 303.7. Together, these sections outline the CEDS planning process, public involvement and data and information to be included in the final document. The South Central Alabama Comprehensive Economic Development Strategy fully meets these requirements. Every effort has been made to create a concise document that encourages participation by

the region's economic partners and stakeholders. The document is less than 55 pages and is organized into four chapters to provide an introduction, a summary of the region's economic characteristics, discussion of economic trends and a SWOT analysis, and an action plan and evaluation framework.

The 2022 South Central Alabama CEDS was developed under the guidance of the South Central Alabama Board of Directors and the South Central Alabama CEDS Committee. Members of the Board of Directors and the CEDS Committee are listed on the inside cover of the document. The private sector of the region is well-represented on both the Board and the CEDS committee. Other members include public officials, community leaders, representatives of workforce development boards, institutions of higher education, minority and labor groups, and private individuals.

The South Central Alabama Development Commission Board of Directors is comprised of 27 representatives of member governments, minority, nonprofit, and business groups from the seven member counties that provide leadership and governance for the SCADC. The directors, who serve without compensation, meet on a quarterly basis to establish policies and guide the implementation of all the district's activities. They are representatives of the people of their area; they are knowledgeable of the conditions that exist in their counties; and they accept as their primary duty the establishment of policies and activities to benefit their counties and the district. An Executive Committee meets as required. The Board's Executive Committee includes the four officers and one board member from each county. Board governance and representation is provided for by the Bylaws established for SCADC and in accordance with the state statute establishing the Regional Councils and Development Districts in Alabama.

A 31-member CEDS Strategy Committee includes business, government and citizen representatives that serve the district by reviewing and recommending the CEDS to the Board. The committee meets periodically and acts as a clearinghouse for projects that affect region. The SCADC staff coordinates the selection of the CEDS Committee with the Board by soliciting suggestions for membership from government leaders and active

citizens interested in economic development.

Working relationships for economic and community development are established between the EDD and the Economic Development Administration, Appalachian Regional Commission, Delta Regional Authority, United States Department of Agriculture and other federal/regional organizations. Relationships with the Alabama Department of Economic and Community Affairs, Office of Workforce Development, Alabama Department of Senior Services, Alabama Department of Commerce, Alabama Department of Transportation and Alabama Emergency Management are important connections maintained through the district organization. Coordination with other regional, city and county economic development organizations, chambers of commerce, public and private utilities and businesses is critical to the region.

The relationships with city and county governments are the core of the District's partnership. SCADC works with the city and county governments in the region on priorities and needs of regional and local concern. The active involvement of these governments in the district is a key to the success of the region and the communities and counties that are part of SCADC. Beyond the formal structure of the Board and participating governments, the SCADC works with, or participates in, numerous related regional or multi-county programs, such as Envision Montgomery 2040, Montgomery Area Chamber of Commerce and programs supported by other chambers of commerce and organizations.

The staff of the South Central Alabama Development Commission provides support as part of the EDD organization. Core staff includes an Executive Director and a Director of Planning and Economic Development, along with other program management and support staff. The EDD maintains an annual and ongoing work program in support of updating, planning and implementation of the CEDS. The work program is essentially the work necessary to support the projects included in the CEDS. The ongoing research, updating and implementation of the CEDS is an integral part of the SCADC agency work program.

Crenshaw County Sports Complex, Crenshaw County



The Crenshaw County Sports Complex is a \$4.3 million project located just south of Luverne in Crenshaw County. The project is being funded through the Land and Water Conservation Fund Program and local matching funds. Walking trails are nearing completion under a \$1.3 million contract. Upon full build-out the complex will include baseball and softball fields, concessions, an RV park and bathhouse, a maintenance building, and walking trails. The park is unique to the region and offers many opportunities to bring sports-related visitors to Crenshaw County.

REGIONAL UPDATE



*Samkee America Inc.,
Tuskegee, Macon County*

Population and Demographics

According to the 2020 Census, the combined population of the seven counties in the South Central Alabama Economic Development District is 334,408 persons. There are 28 municipalities in the SCAEDD area which are home to 78.7 percent of the region's total population, with 60.0 percent of the total population living in Montgomery.

In comparison to the state and the nation, the SCAEDD district has not fared very well in terms of population growth. Between 2010 and 2020, the state and nation had population growth of 5.1 percent and 7.4 percent respectively. Between 2020 and 2022, the state had a small increase of 0.1 percent and the nation had a small population loss of 0.1 percent. In the same time frames, the SCAEDD region suffered a population decline of 8.3 percent between 2010 and 2020 and another decline of 0.4 percent between 2020 and 2022. Not only has the overall population decreased, the district has experienced a slightly larger loss of its working age population, at 5.2 percent, while this population segment increased in the state, at 3.4 percent, and nation, at 6.8 percent.

Population predictions indicate that the SCAEDD district will continue to decline in population through 2035, at which time the population will begin to slowly increase through 2045. By 2050, the SCAEDD district is predicted to have an overall population loss of 4,818 persons, or 1.4 percent. Montgomery and Pike Counties are predicted to have a small population increase over the next 25 years. And, three counties are predicted to have a population loss of more than 10 percent by 2050: Lowndes County, with a 12.3 percent decrease; Butler County, with a 11.0 percent decrease; and Macon County, at a 10.9 percent decrease. Even so, the predicted population loss is not as severe as last year's predictions through 2040 which showed a population decline of 28.9 percent in Lowndes County and 22.0 percent in Macon County by 2040.

SCAEDD Demographic Comparison, 2022

	SCAEDD	Alabama	United States
Population	332,994	5,028,092	331,097,593
Population Change 2010 to 2022	-8.7%	5.2%	7.2%
Change in Working Age Population	-5.2%	3.4%	6.8%
Single Parents w/Kids <18 Living in Poverty	8,334	78,585	3,654,901

Source: STATSAmerica, Regionizer Tool, with 2022 American Community Survey 5-Year Estimates data. www.statsamerica.org

SCAEDD County Population 2000 to 2020 and Projections 2030 to 2050

Location	Census			Projections			Change 2020-2050	
	2000	2010	2020	2030	2040	2050	#	%
Alabama	4,447,100	4,779,736	5,024,279	5,197,874	5,347,155	5,421,450	397,171	7.9%
Bullock	11,714	10,914	10,357	9,603	9,573	9,608	-749	-7.2%
Butler	21,399	20,947	19,051	17,272	16,967	16,947	-2,104	-11.0%
Crenshaw	13,665	13,906	13,194	12,374	12,344	12,393	-801	-6.1%
Lowndes	13,473	11,299	10,311	9,221	9,055	9,044	-1,267	-12.3%
Macon	24,105	21,452	19,532	17,728	17,424	17,407	-2,125	-10.9%
Montgomery	223,510	229,363	228,954	225,218	228,613	230,811	1,857	0.8%
Pike	29,605	32,899	33,009	32,527	33,052	33,380	371	1.1%
SCAEDD	337,471	340,780	334,408	323,943	327,026	329,590	-4,818	-1.4%

Source: U.S. Census Bureau and Center for Business and Economic Research, The University of Alabama, Oct. 2024

Economic Characteristics

In 2020, the SCAEDD district had a combined labor force of 156,161 workers, with an annual average unemployment rate of 8.3 percent. By September 2024, the the labor force had increased to 157,731 workers and the unemployment rate decreased to 3.3 percent. Labor force growth, however, only occurred in Macon, Montgomery and Pike Counties in that time frame.

In the last year between September 2023 and September 2024, the combined SCAEDD labor force increased by 1,487 workers with growth occurring in Bullock, Lowndes, Macon and Montgomery Counties. At the same time, unemployment also increased in all counties except Crenshaw, resulting in a small increase in the unemployment rate, ranging from 0.4 percent increase in Montgomery and Pike Counties to a 1.3 percent increase in Bullock County.

In September 2024, the average annual unemployment rate was lowest in Montgomery County, at 3.2 percent, followed by Bullock and Pike Counties, at 3.3 percent, and highest in Lowndes County, at 5.1 percent. Historically, Lowndes and Macon Counties have maintained the highest unemployment. In contrast, however, Lowndes and Macon also have the highest weekly wages. At the end of the first quarter of 2024, the average weekly wage was \$1,317 in Lowndes County, \$1,145 in Montgomery County, and \$1,060 in Macon County. Crenshaw County has the lowest average weekly wage, at \$849. Montgomery County has the most wage-paying establishments, with 7,218,

followed by Pike County, with 825 establishments, and Butler County, with 549 establishments. Bullock County has the fewest, with 214 establishments, followed by Lowndes County, with 215 establishments.

Average Annual Unemployment Rate

*2024 Average Rate is calculated through September 2024

Year	Bullock	Butler	Crenshaw	Lowndes	Macon	Montgomery	Pike
2024*	3.3%	3.6%	3.2%	5.1%	3.9%	3.2%	3.3%
2023	2.4%	2.9%	2.7%	4.5%	3.2%	2.8%	2.7%
2022	2.8%	3.4%	2.6%	5.2%	3.8%	3.1%	2.7%
2021	3.9%	5.1%	3.3%	8.7%	5.8%	4.7%	3.2%
2020	6.0%	9.5%	6.2%	14.4%	10.4%	8.5%	5.4%

Source: Alabama Department of Labor in cooperation with the Bureau of Labor Statistics.

Average Weekly Wage, 2024

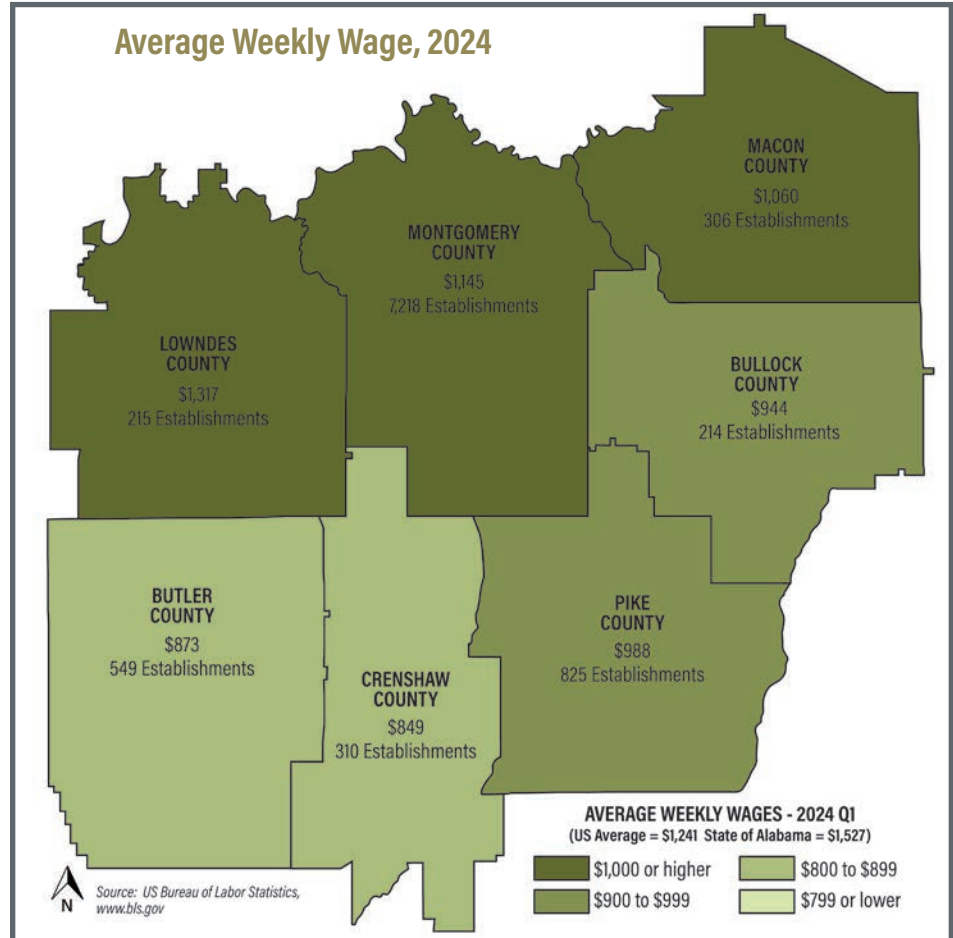

Investment and Development Trends

Economic investment in the SCAEDD district in 2023 totaled \$869,313,625 resulting in five new industries, 21 expanding industries, and 932 jobs. The 2023 economic investment is less than half of the 2022 investment of more than \$1.8 million, although the number of new industries remained the same in the two year and the number of expanding industries only decreased by six from 27 to 21. The total number of new jobs in 2023, however, was also significantly lower than in 2022, at 1,605 new jobs.

Only Lowndes and Pike Counties did not have any new economic investment in 2023. The majority of the growth occurred in Montgomery County with three new industries and 15 expanding industries resulting in 403 new jobs and an investment of more than \$628 million. Macon County attracted two new industries that resulted in 462 new jobs and an investment of \$171 million. Four industries expanded in Crenshaw County, resulting in a \$48 million investment. Bullock and Butler Counties each had one existing industry to expand which resulted in an investment of \$1 million in Bullock County and 67 new jobs and an investment of \$19 million in Butler County.

Over the last ten years from 2014 to 2023, the SCAEDD gained 77 new industries and 305 industrial expansions resulting in an investment almost \$6.8 billion and the creation of 13,502 new jobs. Montgomery County continues to be the economic hub with 59 new industries and 211 industrial expansions

over the ten year period, resulting in 9,700 jobs and a total investment of \$5.02 billion. Butler and Pike Counties follow Montgomery County as economic centers growing around Greenville and Troy, respectively. Pike County had a 10-year investment total of \$634.7 million creating 1,698 new jobs and Butler County had an investment of \$402 million creating 895 new jobs. Crenshaw County had a higher economic investment than Butler County, at \$450 million that created 137 jobs.

Outside of Montgomery County, Butler County had the highest number of new and expanding industries over the last ten years with a combined investment of \$416 million and 979 new jobs. Pike County, however, was second only to Montgomery County in terms of jobs creation and investment with 32 new and expanding industries resulting in A \$665.7 million investment and creation of 1,822 new jobs. Economic investment in Macon County has also increased over the last ten years with a combined total of \$182 million from four new and nine expanding industries resulting in 661 new jobs.

More recent economic development occurring during 2024 in the SCAEDD district includes a new business and an industry expansion in Greenville in Butler County, and an industry relocation to Shorter in Macon County. Connector Manufacturing Company, a Hubbell Company, is undergoing an expansion in Greenville with a \$14 million private investment that will retain 115 existing jobs and create 26 new jobs. The City of Greenville has been awarded \$260,000 in Community Development Block Grant - Economic Development funds and has made application to the Delta Regional Authority for \$2.1 million to resurface Industrial Parkway to support the expansion project. Greenville is also working with SwitchYard to develop a \$2.7 million family-friendly travel stop that provides EV charging, along with dining, a playground, pet-friendly amenities and a boutique marketplace.

The Town of Shorter will be the location of Shinsung Industrial Co., Ltd. An automotive supplier to Hyundai Mobis, Shinsung is relocating from Montgomery County to Shorter and will be expanding their current capacity. Shinsung has committed \$8.5 million in private investment for property acquisition, site preparation, and construction of a new building. The Town of Shorter has committed to \$1 million in infrastructure improvements, including water, sewer and access to support the industry. The relocation and expansion of Shinsung will result in the retention of 20 jobs and the creation of 17 new jobs.

10-Year Economic Investment Trend 2014 through 2023				
County	New Industry	Expanding Industry	Total Investment	Total New Jobs
Bullock County	2	6	\$19,260,000	197
Butler County	5	30	\$402,061,120	895
Crenshaw County	1	21	\$450,322,975	137
Lowndes County	1	6	\$81,820,200	210
Macon County	4	9	\$182,419,000	661
Montgomery County	59	211	\$5,026,619,613	9,704
Pike County	5	22	\$634,768,303	1,698
Total	77	305	\$6,797,271,211	13,502
Source: Annual Industry Reports, Alabama Department of Commerce, 2014 to 2023.				

Pepsi Cola Bottling Company Expansion, Luverne, Crenshaw County



The City of Luverne used \$500,00 in CDBG-ED funds and \$285,625 in local funds to extend water and sewer to a new location for Pepsi Cola Bottling Company. The expansion retained 79 jobs and created ten new jobs. The project was closed out in 2024.

STRATEGY EVALUATION

SCAEDD VISION

Create a region with a viable, self-sustaining economy capable of supporting the highest possible quality of life for every current and future resident.

As the designated Economic Development District for the South Central Alabama Region, the South Central Alabama Development Commission (SCADC) is committed to the ongoing and continual implementation of the CEDS. The planning and economic development staff of the SCADC is currently administering, or otherwise assisting, approximately 65 federal, state and local projects representing \$41.2 million in investment in the SCAEDD. Discussion of 2023 implementation activities categorized by goal is included on the following pages, along with a status update of priority capital improvement projects.

1. ECONOMIC DEVELOPMENT

Promote economic growth with a focused effort on industrial and commercial recruiting, tourism development, resident industry retention programs, entrepreneurial development, and special programs to increase the skill levels of the workforce that will result in higher incomes throughout the region.

2. INFRASTRUCTURE AND TRANSPORTATION

Develop additional and improve upon existing regional infrastructure resources that will facilitate economic growth and the provision of public services.

3. EDUCATION AND WORKFORCE DEVELOPMENT

Improve education systems to ensure that all graduates possess the knowledge and skills to effectively compete for, and perform well in, available jobs.

4. PLANNING AND ENVIRONMENTAL STEWARDSHIP

Balance and manage community and economic development with conservation in an orderly and efficient manner.

5. QUALITY OF LIFE

Improve the existing quality of life in the South Central Alabama Region to meet the needs of all of its citizens.

6. ECONOMIC LEADERSHIP AND FUNDING

Obtain and utilize all financial, organizational and leadership resources to benefit the entire region.

GOAL 1 ECONOMIC DEVELOPMENT

Promote economic growth with a focused effort on industrial and commercial recruiting, tourism development, resident industry retention programs, entrepreneurial development, and special programs to increase the skill levels of the workforce that will result in higher incomes throughout the region.

OBJECTIVES

- Full Employment
- Business Support
- Entrepreneurship
- Expansion and Growth
- Tourism
- Sustainable Development

PROJECTS ON THE GROUND

■ Connector Manufacturing Company, a Hubbell Company.

Connector Manufacturing Company has committed to a \$14 million private investment expansion in Greenville that will retain 115 existing jobs and create 26 new jobs. The City of Greenville has been awarded \$260,000 in Community Development Block Grant - Economic Development funds and has made application to the Delta Regional Authority for \$2.1 million to resurface Industrial Parkway to support the expansion project.

■ Shinsung Industrial Co., Ltd.

Shorter's industrial park off Interstate 85 will be the site for the relocation of Shinsung Industrial Co., Ltd., which is a supplier to Hyundai Mobis. The company will also expand its capacity, retaining 20 jobs and creating 17 new jobs. The project will include an \$8.5 million private investment and \$1 million in infrastructure improvements from the Town of Shorter.

■ SwitchYard Travel Oasis.

A \$2.7 million EV charging station and travel center will be locating in Greenville near Interstate 65 Exit 130. The SwitchYard Travel Oasis will be a family-friendly travel stop that provides EV charging, along with dining, a playground, pet-friendly amenities and a boutique marketplace. Funding for the project includes a \$100,000 local investment, a \$500,000 CDBG-ED grant, and an anticipated \$2.1 million Delta Regional Authority grant.

Future location of Shinsung, a Hyundai Mobis supplier, in Shorter, Macon County.



An electric substation under construction in Tuskegee to support Samkee International, see in background.



Future location of SwitchYard Travel Oasis near Interstate 65 in Greenville, Butler County.



GOAL 2 INFRASTRUCTURE AND TRANSPORTATION

Develop additional, and improve upon existing, regional infrastructure resources that will facilitate economic growth and the provision of public services.

OBJECTIVES

- Adequate Infrastructure
- Facility Standards
- Capital Improvement Programs
- Transportation System
- Transportation Services

PROJECTS ON THE GROUND

■ Brundidge Sewer Improvements.

The Town of Brundidge will use a \$500,000 in SCRC grant, a \$500,000 ADEM grant, and a \$541,000 ADEM DRF loan to make critical improvements to their wastewater treatment plant and to replace sewer mains on Lawson, Nassau and Pine Streets

■ Crenshaw County Water and Road Improvements.

A \$907,742 project in Crenshaw County is making water and road improvements to Star Hope Church Road. Of the total project budget, \$500,000 is CDBG funds and \$407,742 is local match.

■ Fort Deposit Drainage.

The Town of Fort Deposit will use \$400,000 in CDBG funds to make drainage improvements in various locations throughout the town.

■ Franklin Water Improvements.

Franklin received a \$1 million ADEM State Revolving Fund grant to replace 2.75 miles of water main along Alabama Highway 49, from County Road 36 to Interstate 85, resolving the worst of the water system's pressure issues.

A \$472,000 CDBG project for the improvement of four roads in the Ponderosa community of Bullock County was completed and closed out during 2024.



INFRASTRUCTURE AND TRANSPORTATION PROJECTS ON THE GROUND, CONTINUED

■ Glenwood Sewer.

The Town of Glenwood was awarded a \$400,000 CDBG grant to construct a large capacity pumping station necessary to pump the entire town's wastewater to the City of Luverne's system for treatment.

■ Hayneville Sewer Improvements.

The Town of Hayneville received \$759,000 in Delta Regional Authority funds to make improvements to their sanitary sewer lagoon.

■ Lowndes County Road Improvements.

Lowndes County is undertaking a \$611,504 project, of which \$500,000 is CDBG grant funds to make road improvements to Percy Johnson Road, Golson Road East, and the paved portion of Collirene Cutoff Road.

■ Lowndesboro Water Improvements.

Lowndesboro (Lowndes County) is making critical water system improvements using DRA funds. Improvements included replacement of breaking and leaking cast iron mains, line extensions, and installation of fire hydrants. The project will benefit approximately 900 persons.

■ Macon County Road Improvements.

Macon County will match a \$400,000 CDBG grant with \$77,000 in in-kind funds to improve 19 small roads located throughout the county.

■ Mosses Road Improvements.

The Town of Mosses is using \$400,000 in CDBG funds to make improvements to North Main Street in the center of the town.

■ Notasulga Water System Improvements.

Notasulga is using a \$281,522 CDBG grant to replace water valve replacements throughout the town, benefitting 769 people..

■ Shorter Sewer Improvements.

The Town of Shorter will use \$183,000 in ARC funds for sewer design and investigate work; and will use \$625,000 in DRA funds to make improvements to the existing sewer lagoon.

■ Tuskegee Drainage Improvements.

The City of Tuskegee received a \$324,618 Appalachian Regional Commission grant to make drainage improvements throughout the city, benefiting both businesses and residents.

GOAL 3 EDUCATION AND WORKFORCE DEVELOPMENT

Improve education systems to ensure that all graduates possess the knowledge and skills to effectively compete for, and perform well in, available jobs.

OBJECTIVES

- Quality Secondary Education
- Post Secondary Opportunities
- Workforce Training
- Industry and Business Support

The South Central Alabama Mental Health (SCAMH) Rural Crisis Center, a \$10.7 million facility slated to begin construction in Brantley in December 2024, will offer emergency crisis care, as well as mobile crisis response. Working with the Alabama Department of Mental Health, SCAMH has jumpstarted the mobile crisis response program from their headquarters in Andalusia. The

mobile crisis response program delivers immediate support and intervention to individuals experiencing a mental health crisis, regardless of location—whether at home, in public, or elsewhere. SCAMH is hiring new employees and recruiting recent graduates to be fully trained so that when the Rural Crisis Center is complete and opens in 2027, the staff will already be in place. The Town of Brantley provided more than \$3.1 million in infrastructure improvements, funded through the ALDOT Industrial Access Program CDBG-ED, and SCRC, to support the facility.

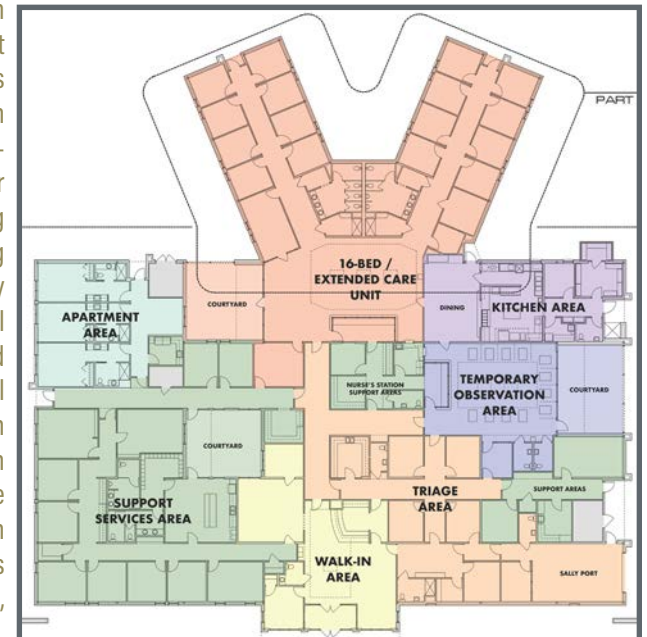

GOAL 4 PLANNING AND ENVIRONMENTAL STEWARDSHIP

Balance and manage community and economic development with conservation in an orderly and efficient manner.

OBJECTIVES

- Land Use
- Natural Resources
- Planning

PROJECTS ON THE GROUND

■ Brantley Land Use Plan

As a result of a 2022 CDBG planning grant, The Town of Brantley annexed additional property to the north, and adopted a new land use plan and subdivision regulations in 2023. In January and February 2024, the Town Council conducted public hearings and adopted the new zoning ordinance.

■ Franklin Land Use Plan

Franklin established a planning commission and undertook a \$36,000 planning process with CDBG Funds. The project's retail market study, land use plan, subdivision regulations, and zoning ordinance were completed in 2023. The plan and subdivision regulations were adopted in March 2023; and the town's first zoning ordinance was adopted in May 2024.

■ Notasulga Comprehensive Plan

Notasulga received a 2022 CDBG Planning grant in the amount of \$32,000 and provided a match of \$2,000 to update their comprehensive plan and develop a new zoning ordinance to replace their dated 1985 zoning ordinance. Both documents are expected to be complete and the project closed out by March 2025.

During the comprehensive planning process, the Town of Notasulga presented concepts for future development in an Open House meeting that was advertised and open to all interested citizens. Attendees were able to review the proposed development concepts, ask specific questions and provide comments for further consideration by the Notasulga Planning Commission.

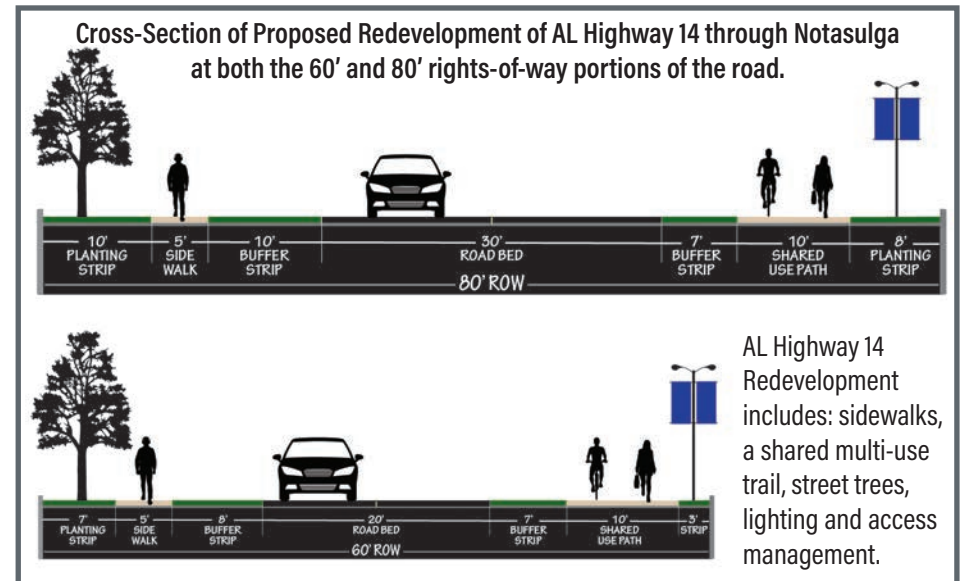



Improve the existing quality of life in the South Central Alabama Region to meet the needs of all of its citizens.

OBJECTIVES

- Health, Safety and Welfare
- Cultural Assets and Aesthetics
- Housing
- Recreation

The Town of Franklin used a 2023 grant from Mid-South RC&D in the amount of \$12,500, matched with \$12,396 in local funds, to install a monument sign with an LED message board in front of Town Hall. The installation of the Franklin Town Hall Sign and Message Board enables the Town to communicate upcoming events, public hearings, and meetings much more clearly and efficiently to local citizens. The sign is located on the primary highway (Alabama Highway 49) through Franklin which provides good access to all residents.



PROJECTS ON THE GROUND

- **Mid-South Resource Conservation & Development (RC&D)**
 - Will Stone Store Improvements, Lowndesboro, \$25,000
 - Franklin Volunteer Fire Department Equipment, \$12,500
 - Shorter Street Sign and Welcome Sign Replacements, \$7,835
- **Crenshaw County Sports Complex:** Crenshaw County received \$500,000 in LWCF and is providing a match \$522,750 for the construction of multi-use trail at the new Crenshaw County Sports Complex. Upon full build-out, the complex will include baseball and softball fields, concessions, an RV park and bathhouse, a maintenance building, and walking trails.
- **Gordonville Park:** Construction of Phase II of a new park in Gordonville will include a walking trail, playground, tennis court, and pavilion funded with a \$400,000 CDBG Enhancement grant.
- **Luverne Splash Pad:** The City of Luverne will use \$115,00 in LWCF and provide a match of \$115,000 to construct a splash pad at Turner Park
- **Ramage Park:** The City of Brundidge is using Recreational Trails Program funds for a \$330,000 project at Ramage Park to extend the walking trail, and add a water feature and lighting.
- **Rutledge Housing Demolition:** The Town of Rutledge will use \$350,000 in CDBG grant funds to demolish up to 15 dilapidated houses in the town along with the dilapidated water tank located behind Rutledge Town Hall.
- **Shorter Park:** The Town of Shorter is using a \$251,956 LWCF grant and provide a match of \$251,956 to build a new park that initially will include a walking trail, pavilion and parking.
- **Washington Maddox Park:** The City of Troy is using Recreational Trails Program funds for a multi-use trail, benches, and lighting. The total project cost is \$402,816.

GOAL 6 ECONOMIC LEADERSHIP AND FUNDING

Obtain and utilize all financial, organizational and leadership resources to benefit the entire region.

OBJECTIVES

- Organizational Structure
- Leadership Development
- Funding

Representatives from the Town of Brantley participated in the Alabama League of Municipalities Economic Development Academy. The program is designed to educate and engage municipal officials on the essential elements and phases of economic development while highlighting their vital role in economic initiatives and projects within their communities. Developed in conjunction with the Alabama Community College System (ACCS) and supported by an advisory council of industry leaders, the Academy engages elected officials from select cities and towns with municipal peers and colleagues from their region to prepare their communities for growth.



PROJECTS ON THE GROUND

■ Section 5310 Funds

SCADC staff submitted two Section 5310 applications to the Alabama Department of Transportation for the purchase of new vehicles for the transport of seniors and disabled persons. Applicants are the Butler County Commission and the Lowndes County Commission.

■ Rural Transportation Planning Organization (RPO)

Funded through the Alabama Department of Transportation and administered by SCAEDD staff, the South Central Alabama Rural Transportation Planning Organization opens a dialogue with stakeholders to determine rural transportation needs and issues.

The proposed Tuskegee Connector Road location will provide a secondary pedestrian and vehicular outlet for Tuskegee University, which is important to minimize congestion and to ensure emergency access.



Tuskegee Connector Road Cross-Section

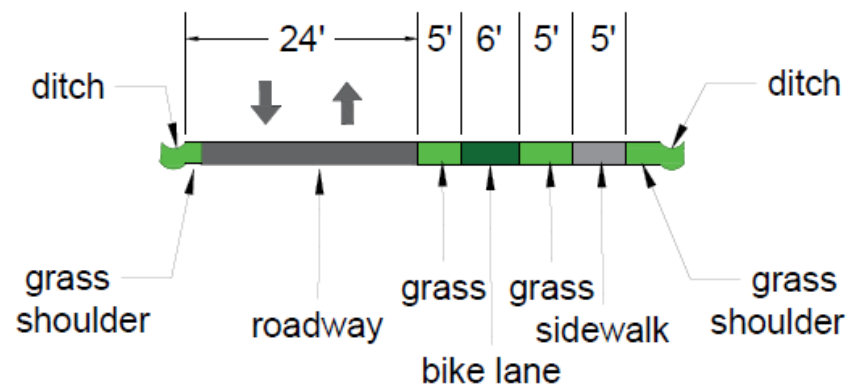

PRIORITY CAPITAL IMPROVEMENT PROJECTS			
Capital Improvement Project	Construction Activity	Cost	Project Status
Water and Sewer			
Brantley Water, Sewer, Road	Extend water and sewer service and create new road to serve new development	\$3 Million	Complete Facility under construction
Luverne Water, Sewer, Road and Site Preparation	Site prep, road and water and sewer improvements	\$2 Million	Complete
Roads			
Alabama Highway 110 Corridor Development	Widen Alabama Highway 110 to four lanes.	TBD	No Update
Development of Federal Highway Corridors: US Highway 80 US Highway 231 US Highway 331	Widen U.S. Highway 331 to four lanes.	\$3 Million	No Update
	U.S. Highway 80 Commercial and Industrial Development	TBD	No Update
	General infrastructure improvements along each corridor.	\$3 Million each	No Update
	U.S. Highway 231 Corridor Study	TBD	No Update
Industrial Parks			
Macon-Tuskegee Industrial Development	Develop a new electrical substation	\$6 million	Under Construction
Miscellaneous			
Revolving Loan Fund	Recapitalize the SCADC Revolving Loan Funds	\$2 Million	Ongoing